



RESSTENDE®

VERANDA *System*

ST-VER-GB

ROLLER BLINDS AS FURNISHING AND ARCHITECTURE - ROLLER BLINDS AS FURNISHING AND ARCHITECTURE - ROLLER BLINDS AS FURNISHING AND ARCHITECTURE

New lifestyles, new blind systems

Resstende S.r.l., a leading Italian company in the production of roller blinds, presents the VERANDA System: a solid and elegant awning designed for verandas and other large horizontal or slanted glassed areas. When installed outdoors, the system provides optimum sun protection and maximum reduction of the greenhouse effect. The Veranda blind has a specially designed traction bar to guarantee constant fabric tension in any position and is therefore ideale not only for horizontal/sloped applications but also vertical windows where the blind is required to open from the ground upwards. The blinds may be installed side by side to form a continuous facade, the double module is operated by a single motor.

PRODUCT DESCRIPTION

Veranda System (model VER507 -VER507D):

Motorised roller blind principally for outdoor installations with a specially designed system to guarantee constant fabric tension in any position. The fabric is kept taut by a large spring inside the traction bar attached to Ø 2.5 mm galvanised steel cables (PES HT) wound onto pulleys (PEHD) mounted on each end of the roller tube. Also available a double module blind (VER507D) operated by a single motor.

Tubular motor: Ø 47 mm (230V/50Hz) with mains cable, adjustable limit switch, thermal cut-out to prevent overheating and water tight housing with level IP44 protection. Optional accessories: remote control with/without incorporated receiver, electronic board for multilevel centralised operation, sun/wind control unit.

The blind structure is made of heavy duty extruded aluminium profiles, consisting of:

Roller tube: Ø 78 mm galvanized steel tube, thickness 1.25 mm, with special groove into which the welded strip on the fabric is inserted.

Box: with removable cover, mod. CV140 (143 x 161 mm) with high resistance cast aluminium lateral cheeks.

Guide rails: mod. GVS (65x65 mm), with high resistance cast aluminium end covers and incorporated pulleys for the cable hidden inside the guide rails.

Traction bar: mod. FV92 with removable cover (80x55 mm) containing the pretensioning system. The traction bar is mounted on ball bearing sliding units.



Fabric: The most suitable fabrics for the Veranda system are SOLTIS 86, SOLTIS 92, SOLTIS B92 and ESTORYL.

The Veranda has a wide choice of fixing brackets for mounting on any surface.

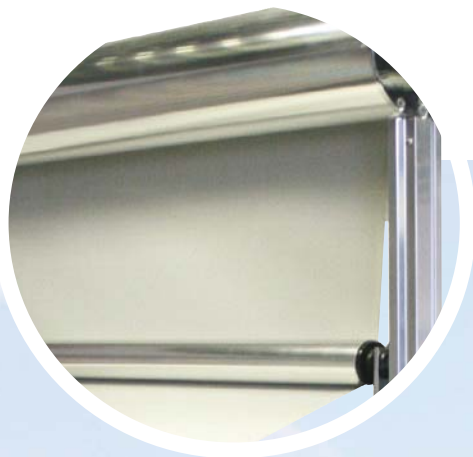

“Solidarietà e Servizi” offices in Varese





Chamber of Commerce in Taranto



Optimum solar protection, and maximum reduction of the greenhouse effect, may be obtained by positioning the blind outdoors at approximately 40 cm from the window pane. The use of a centralised control unit with sun and wind sensors is recommended for outdoor awnings.



Galleria Mazzini in Genoa

Constant fabric tension even when mounted horizontally. The maximum surface area that may be covered is 18 m² per module.

EXPLODED VIEW OF VERANDA AWNING

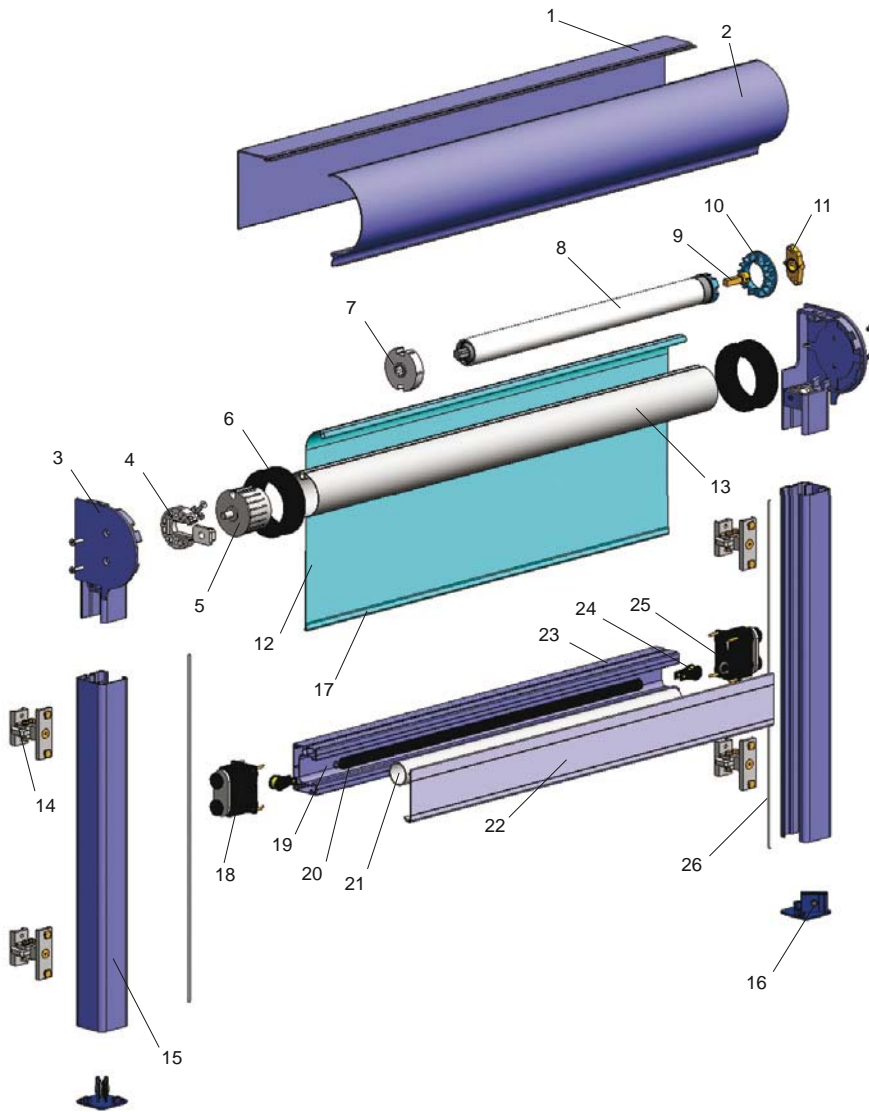

- 1 BOX CV140 FIXED PART
- 2 BOX CV140 REMOVABLE PART
- 3 END CHEEKS CV140
- 4 ALUMINIUM BRACKET
- 5 OPPOSITE SIDE END CAP
- 6 Ø 78 CABLE PULLEY
- 7 Ø 78 MOTOR BRACKET
- 8 TUBULAR MOTOR 30 Nm
- 9 SQUARE PIN FOR MOTOR
- 10 MOTOR ADAPTER Ø78
- 11 MOTOR FIXING BRACKET
- 12 FABRIC
- 13 STEEL ROLLER TUBE Ø78
- 14 MOUNTING BRACKETS TYPE A
- 15 GUIDE RAIL GVS
- 16 GUIDE RAIL CAP GVS
- 17 RIGID Ø 7 mm ROD
- 18 SLIDING UNIT FOR FV92
- 19 CABLE TERMINAL
- 20 SPRING
- 21 PVC TUBE FOR Ø40 SPRING
- 22 TRACTION BAR COVER FV92
- 23 TRACTION BAR FV92
- 24 CABLE BLOCK WITH SWIVEL
- 25 "S" HOOK
- 26 Ø 2.5 mm CABLE

TECHNICAL CHARACTERISTICS

Max wind pressure = 110 N/m²
 (Beaufort scale 6)
 Wind resistance: Class 3



Certificate: AK 60015107
 Model: VER507

TECHNICAL DATA

MODEL	VER507	VER507D
OPERATION	MOTORISED	
NOMINAL COUPLE (Min)	30 Nm	35-40 Nm
OPERATING SPEED	11 cm/s max	
MAX LIFTING WEIGHT	75 Kg	90 Kg
VOLTAGE	230 V / 50 Hz	
ABSORBED CURRENT	1.1 A	
CE MARKING	CEI 60335-2-97 UNI EN 13561	
USERS & MAINTENANCE MANUAL	MT-003	
INSTALLATION SHEETS	SP-001	
MAX DIMENSIONS PER MODULE	Width 450 cm, Height 500 cm max surface area 18 m ²	

FRAME

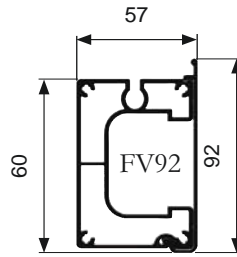
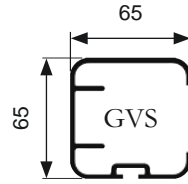
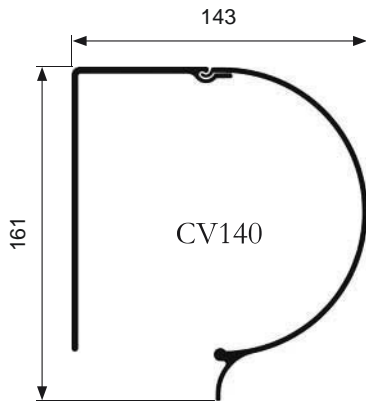

ALUMINIUM FRAME

Extruded aluminium alloy frame (Al 6060 T5). Standard colours available: white (RAL 9010), brown (RAL 8017) & anodised silver. Other powder coated RAL colours are available upon request.

Blind extension (mm)	N° OF BRACKETS	
	1 module	2 modules
upto 1750	4	6
1751 - 2750	6	10
2751 - 4000	8	12
4001 - 5000	10	16

FIXING BRACKETS

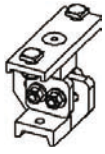

A
level mounting
(standard)

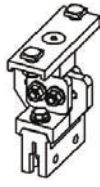

B
embedded mounting

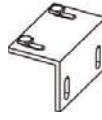

C
lateral mounting with
angle plate 60x60x100

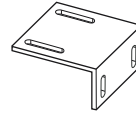

D
lateral mounting with
angle plate 50x100x100



E
distancing bracket
(height 50-200 upon request)

OVERALL DIMENSIONS

SINGLE MODULE (VER507)

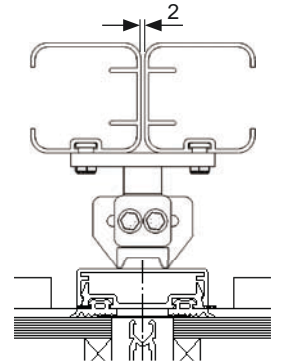
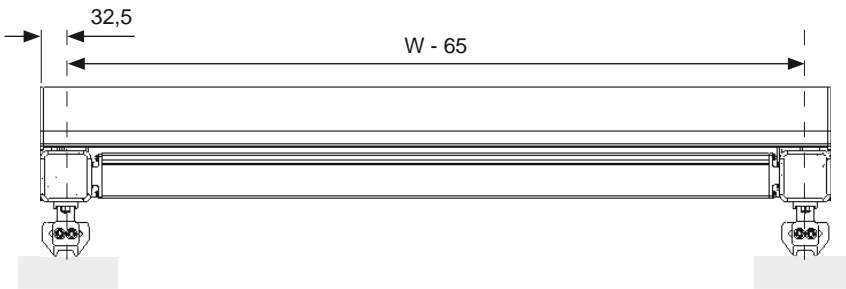

Mounting double module
model VER507D

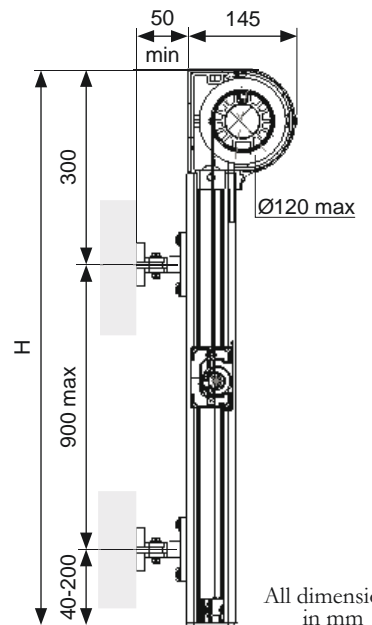
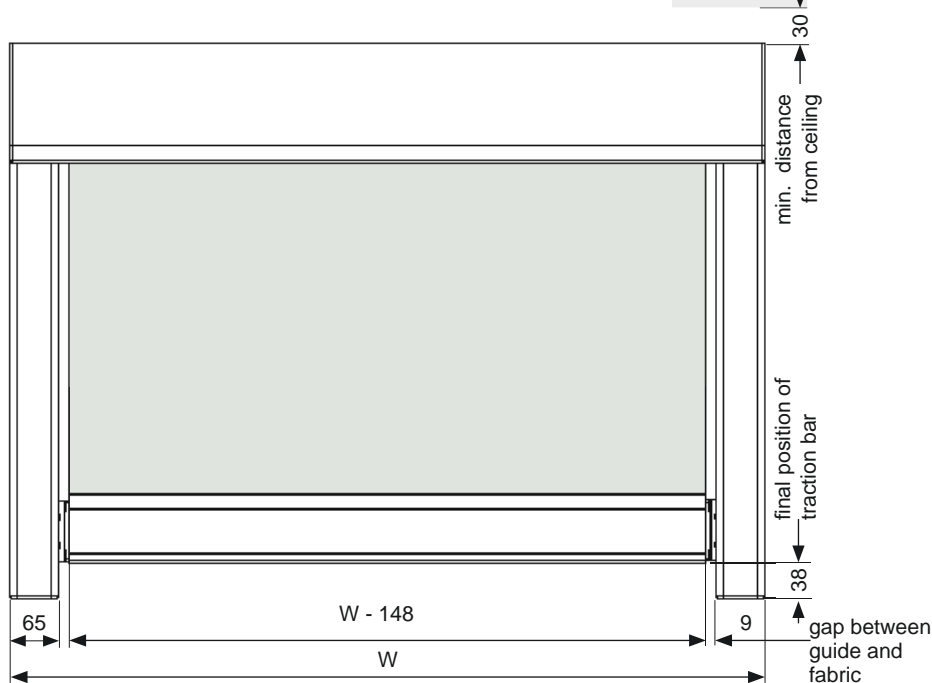

All dimensions
in mm



RESSTENDE

— Nuovi stili di vita, nuovi sistemi di tende —

DS AS FURNISHING AND ARCHITECTURE - ROLLER BLINDS AS FURNISHING AND ARCHITECTURE - ROLLER BLINDS AS FURNISHING AND ARCHITECTURE

Via Ghiringhella, 74 20864 Agrate Brianza (MB) - Italy Tel +39 0396846122 Fax +39 0396846140 Ph. +39 0396846122 Export
info@resstende.com export@resstende.com www.resstende.com