



Aluminium Venetian Blinds 25 & 50mm with Chain or Cords



Venetian Blinds are available in four major categories:

- **Classical** - with a smooth surface - available in a wide range of plain colours.
- **Perforated** - the slats are perforated allowing the possibility of outside visibility.
- **Granite** - printed in a large range of prints and colours
- **Wood Look** - printed in authentic wood look colours.

Venetian Blinds Chain offer a smooth and easy system of movement that contributes to better operation of the blinds resulting in a longer life span.

Thanks to the endless chain, one single command ensures the tilting as well as the raising and lowering of the blinds. This clever yet simple to use system offers practicality to the user.

- The patented **CTS system** (a system with cords for raising and lowering) operates without the use of rotating rods. It also does away with the presence of cords trailing on the floor when the blinds are fully raised.

ALUMINIUM VENETIAN BLINDS WITH CORDS TECHNICAL SPECIFICATIONS & FEATURES

■ The aluminium Venetian Blinds are according to the slat's width **25** and **50mm**. The slats are electrostatic painted ensuring high residence to the humidity and ultraviolet rays.

■ Various **control** options can be used, such as cord, acrylic rod, or electrical controlled by switch, remote control or solar sensor.

■ **The Head Rails** are 25x24mm for the Venetian Blinds 25mm and respectively 58x51mm for the 50mm Aluminium Venetian Blinds. They are 0,4mm thickness reinforced and rolled U-Shaped profiles with the edges turned-in specially designed to offer a harmonious aspect and a secure support. The material is chemically pre treated and stove-enamelled in order to obtain the maximum adherence of the paint and resistance to corrosion.

■ **The bottom rail** is 19x10mm for 25mm blinds and respectively 50x20mm for the 50mm Aluminum Venetian Blinds.

■ **The cord lock** is made of glass-reinforced plastic with two separate cord channels to prevent entanglement of cords ensuring easy lowering, raising and locking of the blinds at any height.

■ **The cords** are 1,4mm diameter made terylene yarn with a reinforced core for smooth and safe operation.

■ **The fixing brackets** are made of reinforced metal and are available in many types enabling the installation in various positions.

■ **The ladder cord-braids** are 21.5x28 for the 25mm and 44x54mm for the Venetian Blinds.

■ **The plastic end cap** for the head and bottom rails are transparent.

■ **Electric operation** controlled by switch, remote control or sun-sensor could be optionally provided.

■ **The Aluminum Venetian Blinds** are made on measure.

Maximum and Minimum Dimensions		
(cm)	25mm	50mm
Max. Width	270cm	400cm
Max. Height	300cm	400cm
Min. Width	19cm	45cm

Dimensions of Slats		
(mm)	25mm	50mm
Thickness	0.21	0.24
Hole	3.4x10.8	3.7x19.2

Stacking Height			
Blind Drop (cm)	Stacking Height 25mm	Blind Drop (cm)	Stacking Height 50mm
100	8cm	70	10cm
120	8.5cm	100	11cm
140	9cm	140	12cm
160	9.5cm	180	13cm
180	10.5cm	220	14cm
200	11cm	270	15cm
		300	16cm

Numbers of Brackets	
Width of Blinds (cm)	Brackets
40 - 90	2
91 - 130	3
131 - 180	4
181 - 270	5

Note: The first bracket is placed between CTS and mechanism

SYSTEM WITH HEAD RAIL 25x24mm WITH CORD

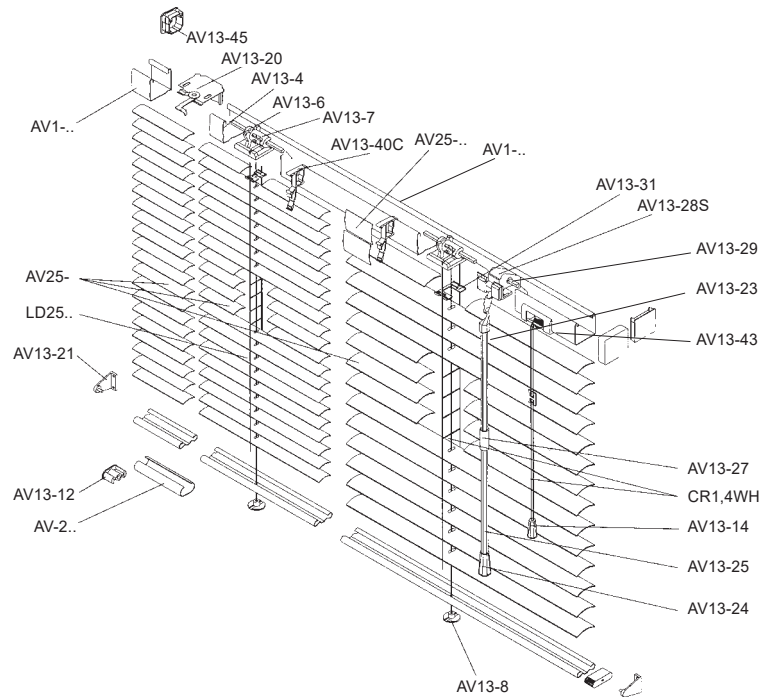

SYSTEM WITH HEAD RAIL 25x24mm (WITH CHAIN)

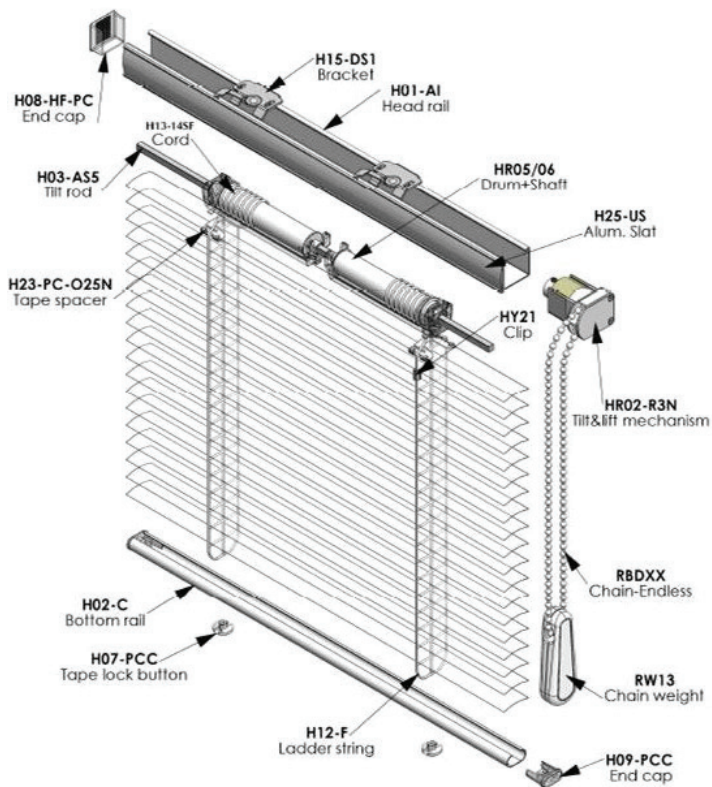

SYSTEM WITH HEAD RAIL 50x58mm (WITH CHAIN)

