



Venetian Blinds 16 & 25mm between double - glazing



The demands of contemporary life and the need for creating comfortable and functional work spaces, have led to the wide use of double glazing in the partitioning of internal spaces.

Architectures propose this as one of the best and most practical solutions because of its many advantages.

The presence of Venetian Blinds between the two panels of double glazed partitions complements the functionality and elegance of this type of partition.

Available in four major categories:

- **Classical**
- **Perforated**
- **Granite look - Printed**
- **Wood look**

The hanging rail, bottom rail, the cords and ladder cords are available in the same colours as the blinds themselves.

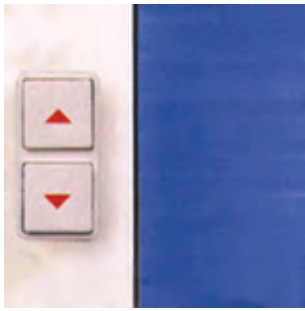

TECHNICAL SPECIFICATIONS & FEATURES

■ The **Aluminium double glazing Venetian Blinds** are according to the slat's width 16 and 25mm. The slats are electrostatic painted ensuring high resistance to the humidity and ultraviolet rays.

■ The **Head Rails** are 25x24mm, 25x25mm or 35x27mm (Softline).

■ The **Bottom Rail** is 19x10mm for 16 and 25mm blinds.

■ The **control** could be made manually by cord, manually with a control knob, or electric operated by switch or remote control.

■ **Absolute protection** of the blind is offered inside the double glazing.

■ The between glazing Aluminium Venetian Blinds are **made on measure** to fit to any special requirement.

WITH CORDS FOR TILTING AND LIFTING

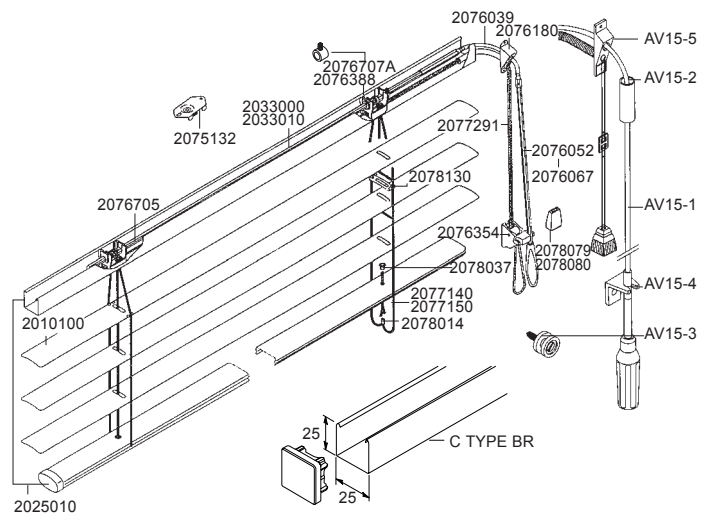

WITH CONTROL KNOB FOR TILTING

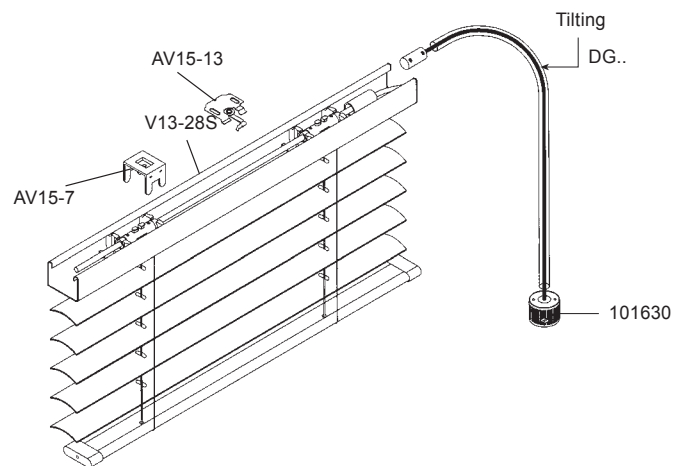

INVISIBLE BRACKET FOR HEAD RAILS 25x25cm and 25x24cm

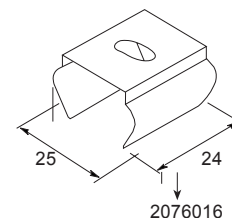

Number of Brackets

Width of Blinds (cm)	Brackets
40 - 120	2
121 - 200	3
201 - 270	4

Maximum and Minimum Dimensions

(cm)	16mm	25mm
Max. Width	150cm	200cm
Max. Height	250cm	300cm
Min. Width	27cm	27cm

Dimensions of Slats

(mm)	16mm	25mm
Thickness	0.22	0.21
Hole	3.4x6.3	3.4x10.8

Stacking Height

Blind Drop (cm)	Stacking Height	
	16mm	25mm
100	8cm	8cm
120	9cm	8.5cm
140	10cm	9cm
160	11cm	9.5cm
180	11.5cm	10.5cm
200	12cm	11cm